

LUMENPOD® 28

Installation Instructions

Another Lumenrail® Component for Life Safety and Light

WARNING: TO REDUCE RISK OF ELECTRIC SHOCK, TURN OFF THE ELECTRICAL SUPPLY BEFORE INSTALLING OR SERVICING THE SYSTEM. FAILURE TO DO SO MAY RESULT IN SERIOUS INJURY AND/OR DAMAGE TO THE COMPONENTS.



LIGHTING SAFETY INSTRUCTIONS

READ THE INSTALLATION INSTRUCTIONS IN THEIR ENTIRETY BEFORE INSTALLING. IT IS IMPORTANT TO LEAVE THESE INSTRUCTIONS WITH THE OWNER OR FACILITY MANAGER OF THE BUILDING FOR FUTURE REFERENCE.

- **Caution:** Installation must be performed by a licensed electrician and all wiring must conform to local, state and national electrical codes
- LED driver: 24VDC, Class 2, configured in a listed system of components
- Mount remote driver(s) in a NEMA rated enclosure
- Systems may be used in a wet location with a suitably rated enclosure and connections
- All electrical components must be grounded and Wagner Architectural recommends connection to a GFCI circuit per local codes and/or the NEC
- This product must be installed in a manner consistent with its intended use
- For trouble-shooting, installation questions and replacement component orders, contact Wagner at 888-243-6914



SCAN QR CODE
for technical information,
downloads and instructions.

Note: Lumenpod® 28 is a 24VDC, low-voltage luminaire. Do not connect Lumenpods® directly to line voltage (120-277-347VAC) or unregulated 24VDC low-voltage supplies. **Failure will result and all warranties will be void.**

RAILING SAFETY INSTRUCTIONS

WAGNER ARCHITECTURAL SYSTEMS ARE ENGINEERED TO MEET IBC, ADA AND NFPA WHEN PROPERLY INSTALLED.

- Check and confirm all local railing code requirements
- A structural analysis may be required per local codes and is the responsibility of the customer
- Verify with the railing manufacturer that intended retrofit installations will not degrade the integrity of their railing
- **Caution:** It is highly recommended that a professional railing installer be used for ANY rail system, illuminated or not
- Please contact the factory for field installations: 888-243-6914 or email us: systems@mailwagner.com

LUMENPOD SUPPLIED PARTS



US PAT. #10,612,734 B2

@wagnercompanies



888-243-6914 // rfq@mailwagner.com
10600 West Brown Deer Road // Milwaukee, WI 53224, USA

© 2023 R&B Wagner, Inc. All Rights Reserved.
WagnerCompanies.com
LULR INST R4

LUMENPOD® 28

Installation Instructions

Another Lumenrail® Component for Life Safety and Light



INSTALLATION

TO REDUCE RISK OF ELECTRIC SHOCK, TURN OFF THE ELECTRICAL SUPPLY BEFORE INSTALLING OR SERVICING THE LIGHT FIXTURES:

For retrofit applications and field drilling for Lumenpod® 28 installations, resealing the protective coating on railings that are not inherently corrosion resistant is required. Paint, cold galvanizing, or an equivalent material must be used to seal the bare metal surfaces prior to fixture installation.

1. Ensure all Pod mounting holes are de-burred inside and out. Removal of all sharp edges is necessary to protect conductors that pass through the openings.
2. Install 24VDC positive (+) and negative (-) wires, 18-14AWG, down the length of the handrail. Cap wires separately at the end of the run.
3. Carefully pull a loop of the 24VDC positive (+) and negative (-) wires out of each Lumenpod mounting hole.
4. Negative (-) wire
 - A. Slide the red 3M Scotchlok™ 905 connector over the unstripped/uncut 24VDC negative (-) wire from handrail.
 - B. Place unstripped negative (-) blue wire from Lumenpod 28 inside the t-tap channel of 3M Scotchlok™ 905 connector.
 - C. Hold pliers perpendicular to the wires and make the connection by driving the u-contact down flush with the top of the plastic insulator body.
 - D. Close hinged top cover until latched.
5. Repeat steps 4A - 4D with the positive (+) wire.
6. Carefully feed wires with 3M Scotchlok™ 905 into the railing, leave fixture hanging and repeat process for additional Lumenpods.
7. On large projects, it is recommended to periodically test wired units (after 4-6 additions), with a 24VDC driver, to verify everything is functional. Use best safety practices at all times.
8. After system is wired and tested completely, carefully feed the remaining wire into the rail. Align the Lumenpod 28 to the preferred orientation. Push Lumenpod 28 into railing opening being careful not to pinch wires. The spring will engage on both sides and lock the Lumenpod into place.
9. Repeat process for additional Lumenpods.



LUMENPOD 28: QUANTITY, DISTANCE & CONDUCTOR SPECIFICATION EXAMPLE

Wire Gauge	16 AWG	14 AWG	12 AWG	10 AWG
Remote Distance To First Pod	20'	45'	70'	95'

Suitable Values for 100W, 24VDC @ 500mA Drive Current With:

42 Pods on 2' spacing using our 100W standard driver
26 Pods on 2' spacing using our 100W USA driver

Actual distances will vary depending on the total load, drive current, wire gauge and fixture spacing. Verify all distance calculations with overall design of system. Conductor supply and gauge specification by others.

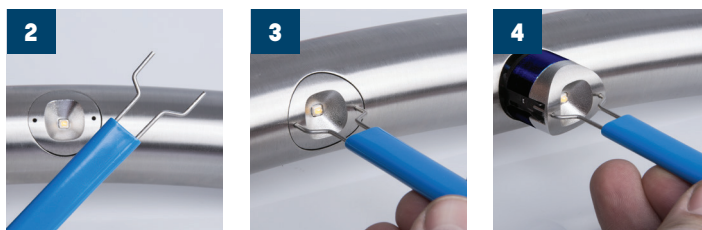

LUMENPOD 28 REMOVAL INSTRUCTIONS

1. To reduce the risk of electric shock, turn off the electrical supply if you need to remove a Lumenpod 28.
2. Locate the removal tool, and align the prongs of the removal tool with the holes in the Lumenpod 28 face.
3. Slowly press the tool into the mating holes with even pressure until the Lumenpod 28 retaining spring releases and the Lumenpod drops out.
4. Disconnect the wires if replacing the Lumenpod, or make the necessary orientation corrections. Follow the installation instructions to reinstall the fixtures.

@wagnercompanies



888-243-6914 // rfq@mailwagner.com
10600 West Brown Deer Road // Milwaukee, WI 53224, USA

© 2023 R&B Wagner, Inc. All Rights Reserved.
WagnerCompanies.com
LULR INST R4